



Frezzi 200W HMI Super Sun-Gun Spare Part List

FREZZI SERVICE INFORMATION

PHONE: (973) 427-1160

FAX: (973) 427-0934

E-MAIL: support@frezzi.com

FREZZI ENERGY SYSTEM

5 VALLEY STREET

HAWTHORNE, NJ 07506

**1. Front Glass Assembly
P/N 3212-1SP**



FRONT RING ASSY 3212-1SP \$125.00

**4. Front Ring
P/N 3253-1SP**



CONTAINS:
 (1)- P/N 3253 Ring Assembly \$40.00
 (4)- P/N 3194 Screw, 4-40 X 3/8 FH \$ 0.20
 (4) -P/N 2020 #4 Kep Nuts \$ 0.12
KIT PRICE 3253-1SP \$40.00

**2. Ear, Sides and Bottom With Screws
P/N 3217-1SP**

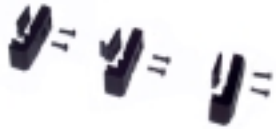

CONTAINS:
 (3)- P/N 3217 Ear \$18.00ea
 (3)- P/N 3256 Glass Standoff \$ 6.50ea
 (1)- P/N 3296 Glass Clip \$15.00
 (3)- P/N 2059 Screw 4-40 X 3/8 \$ 0.35ea
 (3)- P/N 2746 Screw 4-40 X 1/2 \$ 0.35ea
KIT PRICE 3217-1SP \$ 80.00

**5. Reflector Housing Assembly
P/N 1243-1SP**



CONTAINS:
 (1)- P/N 3370A Reinforcement Ring \$ 8.50
 (1)- P/N 1243 Housing Bell \$58.00
 (3) -P/N 3218 Hex Spacers \$ 0.75
 (3)- P/N 3428 Screw, 6-32 X 1/2 PH \$ 0.10
 (3)- P/N 2430 #6 Lockwashers \$ 0.10
KIT PRICE 1243-1SP \$68.00

**3. Top Ear Assembly With Screws
P/N 3390-1SP**



CONTAINS:
 (1)- P/N 3256 Glass Standoff \$ 6.50
 (2)-P/N 2060 Screw, 4-40 X 1/4 PH, BLK \$ 0.35ea
 (1)- P/N 3298 Latch Bar \$ 7.00
 (1)- P/N 3299 Ear Knob \$ 9.00
 (1)- P/N 2757 #4 Lockwasher \$ 0.25
 (1)- P/N 3300 Set Screw \$ 0.25
 (1)- P/N 1278 Spring \$ 1.00
 (1) -P/N 3390 Top Ear \$15.00
 (1)- P/N 3301 Ear Bracket \$18.00
KIT PRICE 3390-1SP \$50.00

**6. Rear Housing
P/N 3155-1SP**



CONTAINS:
 (1)- P/N 2362 Grommet \$0.50
 (2)- P/N 3315 #6 Kep Nut \$0.10EA
 (1)-P/N 3155 Body Housing \$60.00
 Reinforcement Plate \$8.00
 (1)- P/N 3369 Ignitor Bracket Chassis \$11.00
 (3)- P/N 3428 Screw 6-32X1/2 PH \$0.10EA
 (3)- P/N 2430 #6 Lock washer \$0.10EA
S/N 2000-2099
 (2)- P/N 3345 Serated Flange Lock Nut \$2.00
 (2)- P/N 3346 Treaded Mounting Nut \$8.00
 (2)- P/N xxxx External lock washer \$0.10
S/N 2100 AND GREATER
 (2)- P/N 3417 Boss mounting \$12.00
 (4)- P/N 3315 #6 Kep Nut \$0.12
 (4)- P/N 3111 6-32 x 3/8 Pan Head \$0.12
KIT PRICE 3155-1SP \$75.00

7. Pull Pin Assembly
P/N 3330-1SP



CONTAINS:

(1)- P/N 3326	Key Ring, 1/2" OD	\$ 0.40
(1)- P/N 3330	Release Pin Block	\$ 6.90
(1)- P/N 3331	Release Pin	\$ 7.50
(1)- P/N 1278	Spring	\$ 0.84
(2)- P/N 3171	Screw, 2-56 X 3/8 PH, BLK	\$ 0.25

KIT PRICE 3330-1SP \$15.00

10. Safety Switch Assembly
P/N 3233-1SP



CONTAINS:

(1)- P/N 3234	Safety Glass Rod	\$6.00
(1)- P/N 3341	Block, switch actuator	\$8.00
(1)- P/N 3171	Micro Switch	\$3.00
(1)- P/N 2166	Screw, 6-32 X 1/4 PH	\$0.30
(1)- P/N 1278	Spring	\$1.00
(1)- P/N 3233	Bracket, safety sw	\$10.00
(1)- P/N 2060	Screw4-40x1/4 pan	\$ 0.10
(2)- P/N xxxx	Screw4-40x5/16 pan	\$ 0.10

KIT PRICE 3233-1SP \$25.00

8. Focus Assembly
P/N 3219-1SP



CONTAINS:

(1)- P/N 3230	Focus 1" Pin	\$16.50
(1)-P/N 3221	Socket Shaft	\$10.95
(1)- P/N 3219	Socket Block	\$ 4.65
(2)-P/N 2430	#6 Lockwasher	\$ 0.05
(1)- P/N 1259	Z-Bar 650	\$ 7.50
(1)- P/N 1257	Ball Knob	\$ 1.00
(1)- P/N 1261	Focus Disk	\$ 5.10
(2)- P/N 2975	Screw, 4-40 X 1/4	\$ 0.10EA
(1)- P/N 1260	Focus Handle	\$ 3.30
(1)- P/N 3357	Felt Focus Disk	\$ 0.15
(1)- P/N 3356	FocusDisk Brake	\$ 8.00
(2)-P/N 2063	#4 External Tooth Washer	\$ 0.05
(2) P/N 3428	# 6-32X1/2 SCREW PAN	\$0.10EA

KIT PRICE 3219-1SP \$ 56.00

11. Yoke (U-Bracket)
P/N 3330-1SP



CONTAINS:

(1)- P/N 3225	YOKE	\$23.00
(1)- P/N 3320	HANDLE, SIDE	\$17.00
(2)- P/N 3431	1/4 DIA WASHER	\$ 0.30
(1)- P/N 3418	1/4-20 SCREW	\$ 0.60
(1)- P/N 3432	1/4 DIA. SPLIT WASHER	\$ 0.60
(1)- P/N 3394	WING KNOB	\$ 7.50

KIT PRICE 3330-1SP \$50.00

9. Reflector With Hardware
P/N 0893-1SP



CONTAINS:

(1)- P/N 0893	Reflector	\$30.00
(1)- P/N 3295	Gasket	\$ 2.00
(4)- P/N 2101	4-40x1/2 FH PH	\$ 0.10
(4)- P/N 3434	Safety Glass Spacer	\$1.00EA

KIT PRICE 0893-1SP \$35.00

12. Cable Assembly
P/N 3278-1SP



CONTAINS:

(1)- P/N 0832	Ring Terminal	\$ 0.10
(1)- P/N 3277	Male Connector	\$12.50
(1)- P/N 3278	Cable, 5-18 12ft	\$16.50

KIT PRICE 3278-1SP \$29.00

**13. Ignitor
P/N 3228-1SP**



CONTAINS:

- | | |
|--------------------------------|----------|
| (1)- P/N 3228 IGNITOR | \$200.00 |
| (2)- P/N 3314 SCREW 2-56X1"PAN | \$ 0.10 |

KIT PRICE 3226-1SP \$200.00

**14. Ignitor Box Mechanical Assembly
P/N 3226-1SP**



CONTAINS:

- | | |
|--------------------------------------|---------|
| (1)- P/N 3226 CHASSIS, IGN. | \$35.00 |
| (1)- P/N 4183 SWITCH | \$ 4.50 |
| (1)-P/N 3249 STRAIN RELIEF | \$ 2.25 |
| S/N 2000-2099 | |
| (4)- P/N 2060 SCREW 4-40 X .25 PH | \$ 0.10 |
| S/N 2100 AND GREATER | |
| (4)- P/N 2088 SCREW 4-40 X .25 FH UC | \$ 0.10 |

KIT PRICE 3226-1SP \$42.00

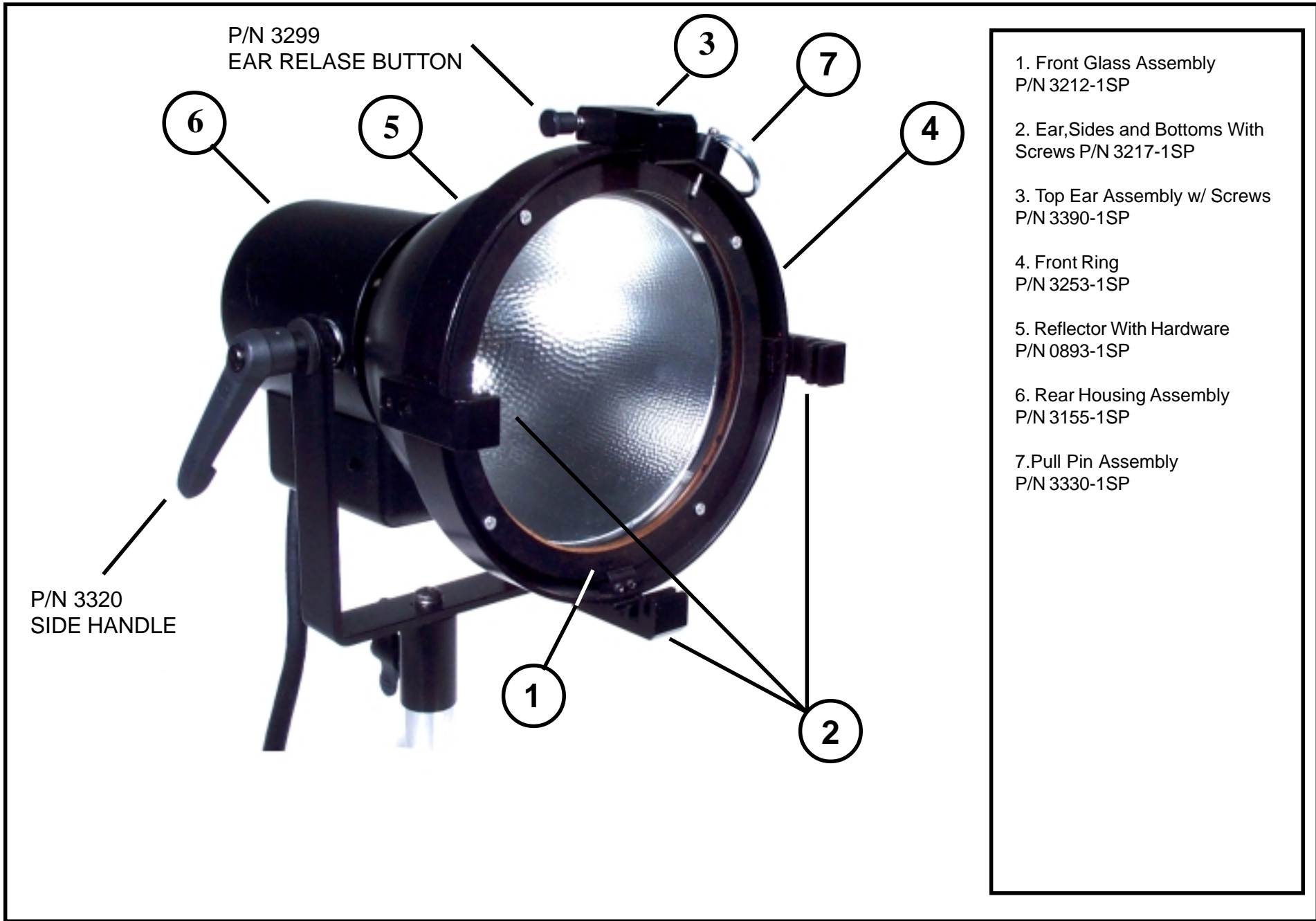

P/N 3299
EAR RELEASE BUTTON

6

5

3

7

4

1

2

P/N 3320
SIDE HANDLE

- 1. Front Glass Assembly
P/N 3212-1SP
- 2. Ear, Sides and Bottoms With
Screws P/N 3217-1SP
- 3. Top Ear Assembly w/ Screws
P/N 3390-1SP
- 4. Front Ring
P/N 3253-1SP
- 5. Reflector With Hardware
P/N 0893-1SP
- 6. Rear Housing Assembly
P/N 3155-1SP
- 7. Pull Pin Assembly
P/N 3330-1SP



P/N 3418
SCREW 1/4-20
PAN PHIL.

11

13

P/N 3418
SCREW 1/4-20
PAN PHIL.

P/N 3394
WING KNOB

8

12

8. Focus Assembly
P/N 3219-1SP

11. Yoke Assembly
P/N 3330-1SP

12. Cable Assembly
P/N 3278-1SP

13. Ignitor Box Mechanical
Assembly
P/N 3226-1SP

